

1

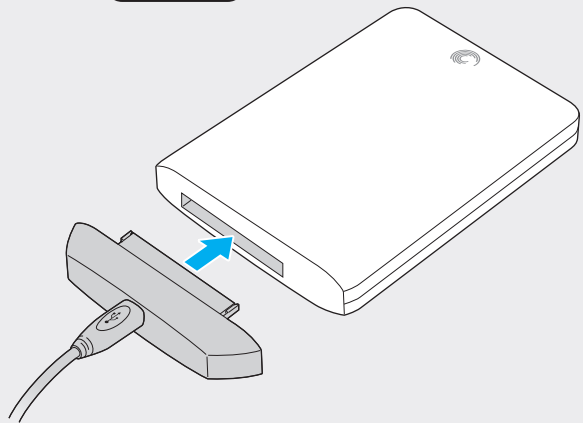

2

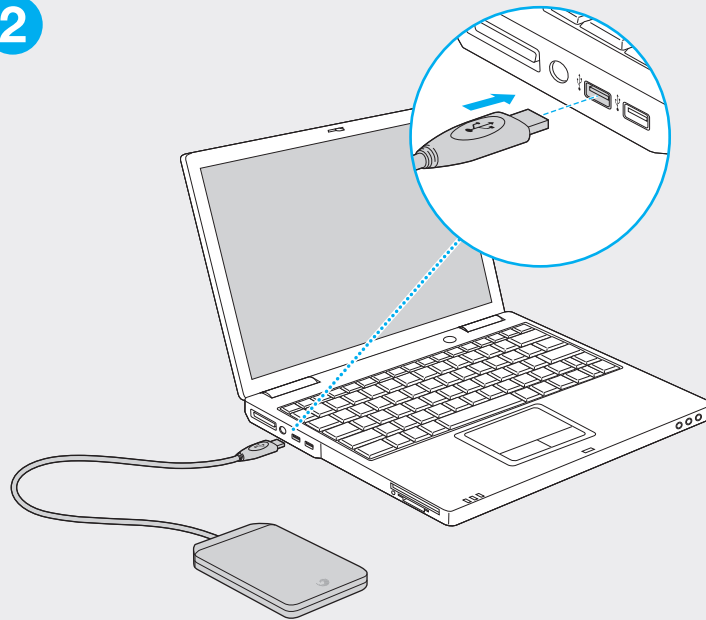

3

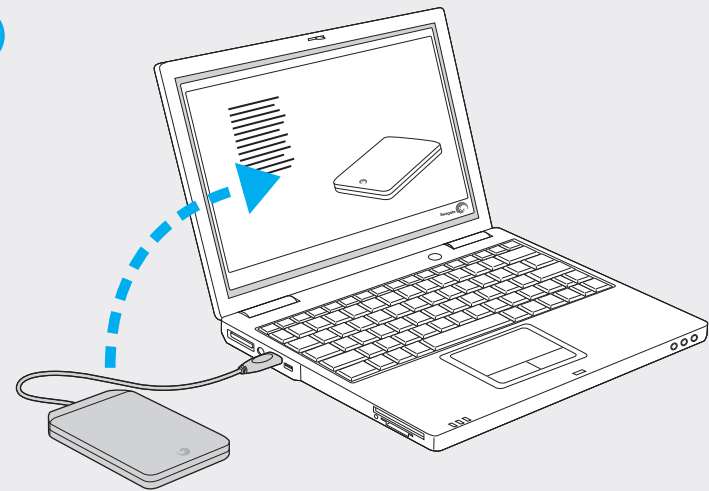

EN After drive is connected, software installer automatically launches within two minutes.

Double-click Setup.exe on drive or visit <http://support.seagate.com/autorun> if the software installer doesn't automatically launch.

TO USE WITH MAC OS® OPERATING SYSTEMS, PLEASE VISIT <http://support.seagate.com/mac>.

FR Une fois le disque connecté, le programme d'installation du logiciel se lance automatiquement en l'espace de deux minutes.

Double-cliquez sur Setup.exe sur le disque ou consultez la page <http://support.seagate.com/autorun> si le programme d'installation du logiciel ne se lance pas automatiquement.

POUR UNE UTILISATION AVEC UN SYSTÈME D'EXPLOITATION MAC OS®, CONSULTEZ LA PAGE <http://support.seagate.com/mac>.

ES Una vez conectada la unidad, el instalador de software se iniciará automáticamente en dos minutos.

Haga doble clic en Setup.exe en la unidad o visite <http://support.seagate.com/autorun> si el instalador no se inicia automáticamente.

PARA SU USO CON LOS SISTEMAS OPERATIVOS DE MAC OS®, VISITE <http://support.seagate.com/mac>.

BR Depois que a unidade estiver conectada, o instalador do software será automaticamente iniciado em dois minutos.

Clique duas vezes em Setup.exe na unidade ou acesse <http://support.seagate.com/autorun> se o instalador do software não iniciar automaticamente.

PARA USO COM SISTEMAS OPERACIONAIS MAC OS®, ACESSE <http://support.seagate.com/mac>.

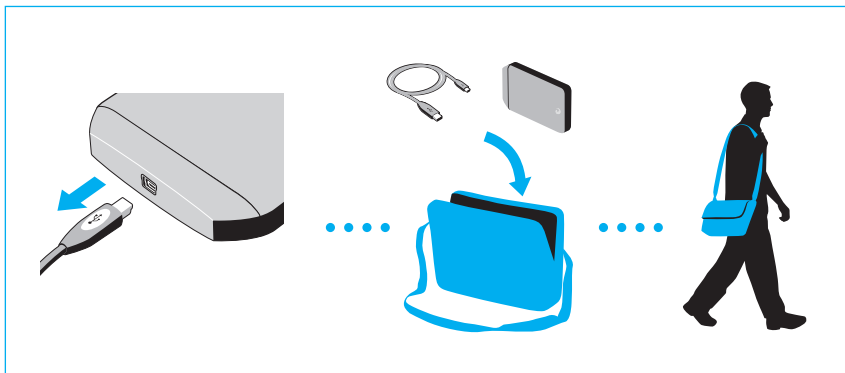

EN WWW.SEAGATE.COM

Visit us at our Support pages for assistance with:

- **Installation:** Additional instructions and troubleshooting assistance
- **Knowledge Base:** FAQ's, How to use this product
- **Download Center:** Installation software, utilities and diagnostics
- **Warranty Information**
- And all of your other storage needs

To contact support, visit us at our **Contact Us** page.

NOTE: To protect your data, always follow the safe removal procedures for your operating system when disconnecting your product.

FCC DECLARATION OF CONFORMANCE

This device complies with Part 15 of the FCC Rules. Operation is subject to the following two conditions: (1) this device may not cause harmful interference, and (2) this device must accept any interference received, including interference that may cause undesired operation.

CLASS B

This equipment has been tested and found to comply with the limits for a Class B digital device, pursuant to Part 15 of the FCC Rules. These limits are designed to provide reasonable protection against harmful interference in residential installation. This equipment generates, uses, and can radiate radio frequency energy and, if not installed and used in accordance with the instructions, may cause harmful interference to radio communications.

However, there is no guarantee that interference will not occur in a particular installation. If this equipment does cause harmful interference to radio or television reception, which can be determined by turning the equipment off and on, the user is encouraged to try to correct the interference by one or more of the following measures:

- Reorient or relocate the receiving antenna.
- Increase the separation between the equipment and receiver.
- Connect the equipment into an outlet on a circuit different from that to which the receiver is connected.
- Consult the dealer or an experienced radio/TV technician for help.

CAUTION: Any changes or modifications made to this equipment may void the user's authority to operate this equipment.

FR WWW.SEAGATE.COM

Consultez les pages de support technique de notre site pour toute question relative aux points suivants :

- **Installation :** instructions supplémentaires et assistance dépannage
 - **Base de connaissances :** FAQ, procédure d'utilisation du produit
 - **Centre de téléchargement :** logiciels d'installation, utilitaires et diagnostics
 - **Informations sur la garantie**
 - Et toutes vos questions relatives au stockage des données
- Pour contacter le support technique, consultez la page **Nous contacter**.

REMARQUE : pour protéger vos données, suivez toujours les procédures de retrait sécurisé correspondant à votre système d'exploitation lors de la déconnexion du produit.

ES WWW.SEAGATE.COM

Consulte nuestras páginas de asistencia técnica para recibir ayuda sobre:

- **Instalación:** Instrucciones adicionales y asistencia para la resolución de problemas
- **Base de conocimientos:** Preguntas más frecuentes y modo de utilización de este producto
- **Centro de descargas:** Software de instalación, utilidades y diagnóstico
- **Información de garantías**
- Y todas sus demás necesidades de almacenamiento

Para obtener datos de contacto, consulte nuestra página **Contacto**.

NOTA: Para proteger sus datos, asegúrese de seguir los procedimientos de extracción segura de su sistema operativo siempre que desconecte el producto.

BR WWW.SEAGATE.COM

Visite nossas páginas de Suporte para obter ajuda com:

- **Instalação:** instruções adicionais e assistência para solução de problemas
- **Base de Conhecimento:** perguntas frequentes, Como utilizar este produto
- **Download Center (Centro de downloads):** software de instalação, utilitários e diagnóstico
- **Informações sobre garantia**
- E todas as suas necessidades de armazenamento

Para entrar em contato com o suporte, visite nossa página **Contact Us** (Entre em contato conosco).

NOTA: Para proteger seus dados, sempre siga os procedimentos de remoção segura do seu sistema operacional ao desconectar o produto.

© 2010 Seagate Technology LLC. All rights reserved. Seagate, Seagate Technology, the Wave logo, FreeAgent, and GoFlex are trademarks or registered trademarks of Seagate Technology LLC, or one of its affiliated companies in the United States and/or other countries. All other trademarks or registered trademarks are the property of their respective owners. Seagate reserves the right to change, without notice, product offerings or specifications.

Seagate Technology LLC
920 Disc Drive
Scotts Valley
CA 95066 U.S.A.

PN: 100612551 02/10



QUICK START GUIDE
GUIDE DE DÉMARRAGE RAPIDE
GUÍA DE INICIO RÁPIDO
GUIA DE INÍCIO RÁPIDO

FreeAgent®
GoFlex™
ULTRA-PORTABLE DRIVE