

1 Pre Installation

Thank You

Thank you for selecting the Maxtor Personal Storage 3000LE. Please follow these installation instructions to reap the full benefits of your purchase.

USB Backward Compatibility

The Maxtor Personal Storage 3000LE is backward compatible and can be used with current computer systems with built-in USB 1.1 ports. If your computer does not have USB 2.0 support built in, a USB 2.0 PCI adapter card is required to achieve USB 2.0 data transfer rates.

Handling Precautions

If these handling precautions are not followed, damage to the 3000LE may result and your warranty may become void. Please see the Warranty section for additional information.

- DO NOT bump, jar or drop this device as it may cause loss of data.
- DO NOT stack device more than three units high.
- DO NOT set the device on its side as it may fall over and damage the internal hard drive.
- DO NOT remove any cables or power without properly disconnecting the device via your operating system – as this may cause data loss and possible damage to the internal hard drive.
- DO NOT set any liquids or drinks on the device. Liquids will damage the internal electronics.
- DO NOT attempt to open the device. It will void the warranty.
- NOT intended as a portable device.

Hardware and Operating System Requirements for Macintosh

- PowerPC with on-board USB port (iMac, G3 or higher)
- Mac OS 9.0 or higher
- 32MB of RAM
- Internet connection

2 Kit Components

The Maxtor Personal Storage 3000LE comes complete with the components shown here. Please familiarize yourself with each of these items prior to installation.



Personal Storage 3000LE



Power Adapter



USB Interface Cable



CD-ROM

3 Hardware Installation

Personal Storage Installation

To connect your new Maxtor Personal Storage 3000LE to your computer, please follow these simple steps. If these steps are not performed in order, the 3000LE may not function properly.

Power Cord Connections

1. Ensure that your computer is turned on and is running one of the required operating systems.
2. Plug the four-pin male connector with the flat side facing up into the back of the 3000LE's DC power-in connector (Figure 1).

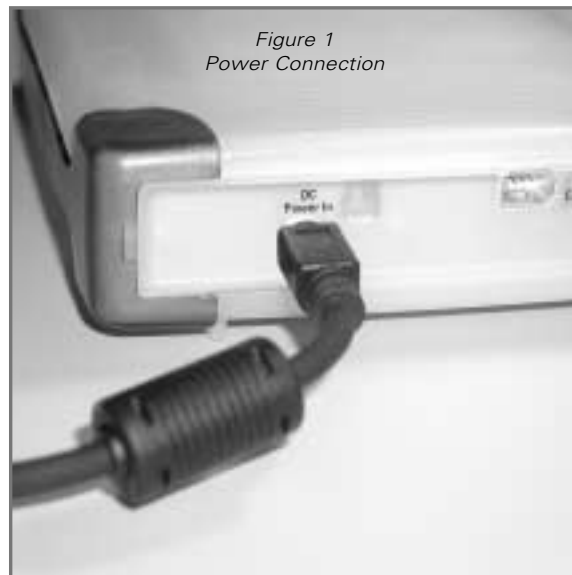

3. Connect the female end of the power cord into the power adapter (Figure 2).

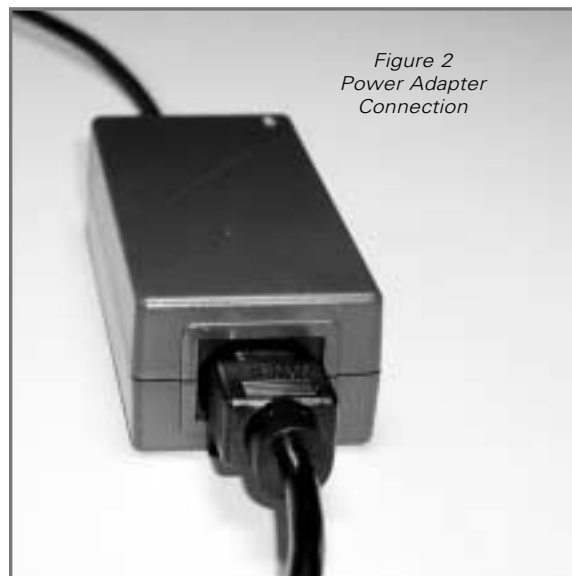

4. Plug the male connector from the power adapter into your power source.

USB Data Cable Connections

1. Plug the larger end of the USB cable into any available USB port on your computer.
2. Plug the smaller end of the USB cable into the USB connection on the 3000LE (Figure 3).

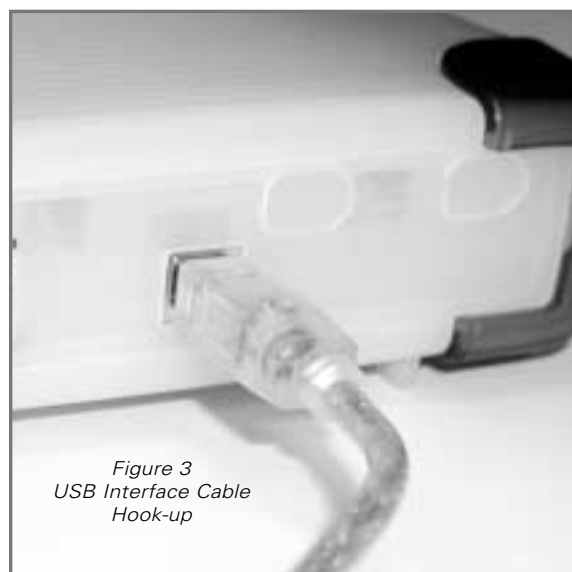

Figure 3
USB Interface Cable
Hook-up

4 Macintosh Software Setup

1. Please close all open programs before you begin the software installation.
2. Insert the Maxtor CD into your CD-ROM drive.
3. Double-click on the Maxtor Software Installer icon. The license agreement screen will display. Click "I Agree."
4. In the Save dialog box, click "Save" to create a folder on your desktop called "Maxtor USB Device."
5. Click Restart.

You are now ready to use your new Maxtor Personal Storage 3000LE.

For your convenience, Maxtor has formatted the 3000LE with one large PC-DOS file structure. To change the file structure, please follow these steps:

1. Go to the folder where you have saved the Maxtor Utilities files and double-click on the "Maxtor Utilities" icon. You will see the setup utility:



2. With the Maxtor USB Device highlighted, click on the "Setup" button. You will then receive a data protection warning. If you don't have data that you want to keep, click on "OK."

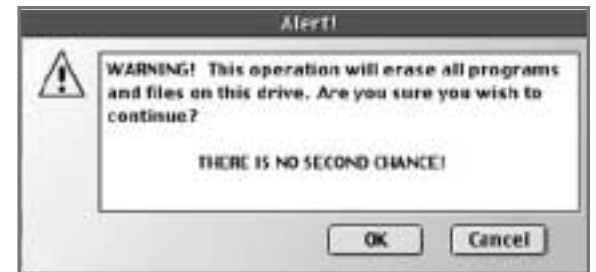

3. Select the Volume format you want to use.

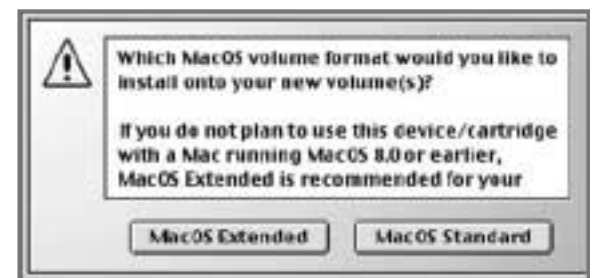

When the initialization has completed, the Maxtor Utility screen will reappear. You are now ready to use your new Maxtor Personal Storage 3000LE with your desired file system.

Disconnecting the 3000LE

While in the Finder, **drag** the **drive icon** to the **Trash**. Then you may disconnect your 3000LE.

Reattaching the 3000LE

To re-attach the 3000LE, simply **re-insert** the **USB cable** into the 3000LE and your computer. Make sure the 3000LE is getting power.

Please see the reverse side of this poster for Product Registration and Warranty information.

Changes are periodically made to the information herein – which will be incorporated in revised editions of the publication. Maxtor may make changes or improvements in the product(s) described in this publication at any time and without notice. This product tested to comply with FCC standards for home or office use.

Copyright© 2001 Maxtor Corporation. All rights reserved. Printed in the U.S.A. 9/01. Maxtor® is a registered trademark of Maxtor Corporation. Other brands or products are trademarks or registered trademarks of their respective holders.

1 Pre Installation

Thank You

Thank you for selecting the Maxtor Personal Storage 3000LE. Please follow these installation instructions to reap the full benefits of your purchase.

USB Backward Compatibility

The Maxtor Personal Storage 3000LE is backward compatible and can be used with current computer systems with built-in USB 1.1 ports. If your computer does not have USB 2.0 support built in, a USB 2.0 PCI adapter card is required to achieve USB 2.0 data transfer rates.

Handling Precautions

If these handling precautions are not followed, damage to the 3000LE may result and your warranty may become void. Please see the Warranty section for additional information.

- DO NOT bump, jar or drop this device as it may cause loss of data.
- DO NOT stack device more than three units high.
- DO NOT set the device on its side as it may fall over and damage the internal hard drive.
- DO NOT remove any cables or power without properly disconnecting the device via your operating system – as this may cause data loss and possible damage to the internal hard drive.
- DO NOT set any liquids or drinks on the device. Liquids will damage the internal electronics.
- DO NOT attempt to open the device. It will void the warranty.
- NOT intended as a portable device.

Hardware and Operating System Requirements for Windows PC

- Pentium II-class equivalent processor or higher
- 32MB of RAM
- Available USB 1.1* or USB 2.0 port
- Internet connection
- CD-ROM drive
- Windows 98 Second Edition, Windows Millennium, Windows 2000 or Windows XP

* Upgrade to USB 2.0 with a Maxtor USB 2.0 Adapter Card (optional)

2 Kit Components

The Maxtor Personal Storage 3000LE comes complete with the components shown here. Please familiarize yourself with each of these items prior to installation.



Personal Storage 3000LE



Power Adapter



USB Interface Cable



CD-ROM

3 Hardware Installation

Personal Storage Installation

To connect your new Maxtor Personal Storage 3000LE to your computer, please follow these simple steps. If these steps are not performed in order, the 3000LE may not function properly.

Power Cord Connections

1. Ensure that your computer is turned on and is running one of the required operating systems.
2. Plug the four-pin male connector with the flat side facing up into the back of the 3000LE's DC power-in connector (Figure 1).



3. Connect the female end of the power cord into the power adapter (Figure 2).

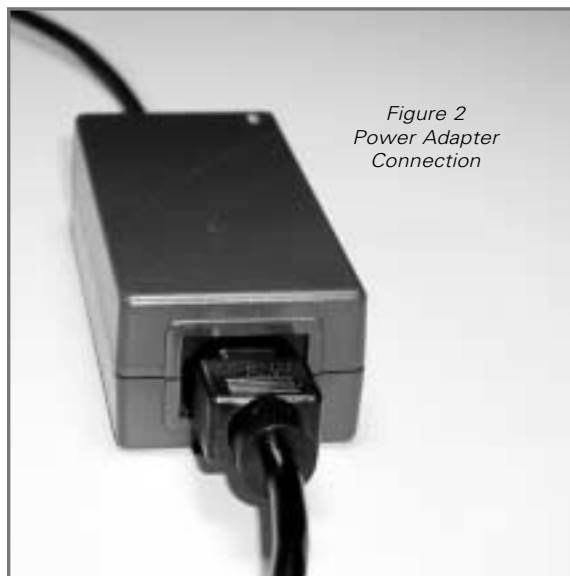

4. Plug the male connector from the power adapter into your power source.

USB Data Cable Connections

1. Plug the larger end of the USB cable into any available USB port on your computer.
2. Plug the smaller end of the USB cable into the USB connection on the 3000LE (Figure 3).

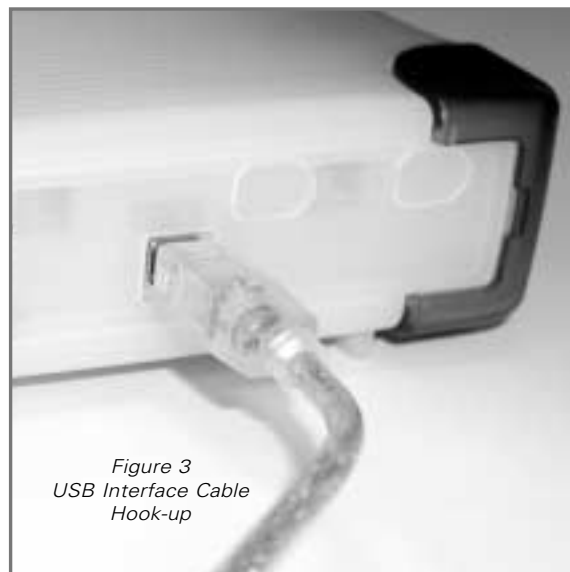

4 Windows PC Software Setup

Windows Millennium/2000/XP

Maxtor has completely setup your new Personal Storage 3000LE with one large FAT32 partition.

1. Start your computer.
2. Plug the larger end of the USB cable into any USB port on your computer.
3. Windows will detect the "USB Mass Storage Device" and install the drivers for it.
4. Restart your system.

You are now ready to use your new Maxtor Personal Storage 3000LE.

Windows 98SE

Additional drivers are required to use the Maxtor Personal Storage 3000LE with Windows 98SE. Please follow these steps for proper installation.

1. Without attaching the 3000LE, start your computer.
2. Insert the Maxtor CD into your CD-ROM drive.
3. Follow the on-screen prompts.
4. Once the installer is finished, restart your computer.
5. Plug the larger end of the USB cable into any USB port on your computer.
6. Windows will detect "USB Mass Storage Device."

You are now ready to use your new Maxtor Personal Storage 3000LE.

Disconnecting the 3000LE

Right click on the Windows **Unplug** or **Eject Hardware** icon in your system icon tray located at the bottom right corner of your screen.

Reattaching the 3000LE

1. Plug the male connector from the power cord into your electrical wall outlet.
2. Plug in the smaller end of the USB cable into the USB connection on the 3000LE.

5 Product Registration

Take advantage of the benefits!

By registering your new 3000LE, you'll have the option to receive product updates, special offers, and important information about other data storage solutions from Maxtor.

Simply point your web browser to: www.maxtor.com – go to the product registration page, and complete the short questionnaire.

Product Warranty

Maxtor's warranty obligations are limited to the terms set forth: Maxtor warrants only to the original consumer purchaser that new Maxtor products will be free from defects in material and workmanship for 1 year from the date of original purchase.

For a replacement product, the warranty on the replacement device is the remainder of the warranty on the original device or 90 days, whichever is longer. If you discover a defect, Maxtor will, at its option, repair or replace the product at no charge to you, provided you return it during the warranty period, with transportation charges prepaid, to Maxtor in Ireland, Singapore or the USA.

Products must be properly packaged in Maxtor packaging or Maxtor approved packaging to obtain warranty service. Before returning a Maxtor product, please contact Maxtor at: +353 1 204 1111 (in Europe) or 1-800-2MAXTOR (in U.S.) to obtain a Return Material Authorization (RMA) number. A copy of the receipt or a bill of sale bearing the appropriate Maxtor serial number and model number may be required for warranty service. The warranty applies only to the Maxtor products that can be identified by the Maxtor trademark, trade name, serial number or logo affixed to them. Maxtor does not warrant any product that is not manufactured by, for or with permission from Maxtor.

This warranty is not applicable to: Abnormal wear and tear; Abuse, unreasonable use, mistreatment, or neglect; Damage caused during installation of the Product; Damage caused by the equipment or system with which the product is used; Damage caused by modification or repair not made or authorized by Maxtor; Product whose Maxtor Serial Number has been removed or defaced; Damage caused by liquids in the product case; Damage to the products' interface or power connectors; Damage caused by use of non-Maxtor packaging; Damage caused by improper or improperly used packaging; Products that are determined to be stolen.

THIS WARRANTY AND REMEDIES SET FORTH ABOVE ARE EXCLUSIVE AND IN LIEU OF ALL OTHERS, WHETHER ORAL OR WRITTEN, EXPRESSED OR IMPLIED. MAXTOR SPECIFICALLY DISCLAIMS ANY AND ALL IMPLIED WARRANTIES, INCLUDING, WITHOUT LIMITATION, WARRANTIES OF MERCHANTABILITY AND FITNESS FOR A PARTICULAR PURPOSE AND AGAINST INFRINGEMENT. ADDITIONALLY, MAXTOR DOES NOT WARRANT THAT THE INSTALLATION SOFTWARE FOR WINDOWS OS WILL MEET YOUR REQUIREMENTS NOR THE PERFORMANCE OR RESULTS THAT THE OPERATION OF THE PROGRAM WILL BE UNINTERRUPTED OR ERROR FREE. NO MAXTOR DEALER, AGENT OR EMPLOYEE IS AUTHORIZED TO MAKE ANY MODIFICATION, EXTENSION OR ADDITION TO THIS WARRANTY.

MAXTOR IS NOT RESPONSIBLE FOR SPECIAL, INCIDENTAL, INDIRECT OR CONSEQUENTIAL DAMAGES RESULTING FROM ANY BREACH OF WARRANTY, OR UNDER ANY OTHER LEGAL THEORY, INCLUDING BUT NOT LIMITED TO LOSS OF DATA, LOSS OF PROFITS, DOWNTIME, GOODWILL, DAMAGE OR REPLACEMENT OF EQUIPMENT AND PROPERTY, AND ANY COSTS OF RECOVERING, PROGRAMMING OR REPRODUCING ANY PROGRAM OR DATA STORED IN OR USED WITH MAXTOR DISK DRIVES OR MAXTOR PRODUCTS CONTAINING MAXTOR DISK DRIVES OR ANY SOFTWARE PRODUCT DISTRIBUTED THEREWITH.

Some states/jurisdictions do not allow the exclusion or limitation of incidental or consequential damages or exclusions of implied warranties, so the above limitations or exclusions may not apply to you. This warranty gives you specific legal rights, and you may also have other rights that vary from jurisdiction to jurisdiction.