



# Seagate Lyve Mobile Shuttle User Manual

---



**Click here to access an up-to-date online version** of this document. You will also find the most recent content as well as expandable illustrations, easier navigation, and search capability.

# Contents

<b>1</b>	<b>Introduction</b>	<b>5</b>
	Box content	5
	Minimum system requirements	5
	• Computer port	5
	• Operating system	5
	• Minimum free disk space	5
	Specifications	6
	• Dimensions	6
	• Weight	6
	• Electrical	6
	• Temperature ranges	6
	Ports	6
	E-Ink screen	7
	Carrying handle	7
	Status LED	7
	Shipping case	8
<b>2</b>	<b>Getting Started</b>	<b>9</b>
	Connect the power cable	9
	View the E-Ink display	10
	Lyve Drive Shuttle is ready	10
	• Initial configuration	11
	• Site credentials	11
	Register Lyve Drive Shuttle	11
	Power off/on Lyve Drive Shuttle	12
<b>3</b>	<b>Security</b>	<b>13</b>
	Create a password	13
	Change a password	13
	Unlock device	13
	Lock device	14
<b>4</b>	<b>Desktop Operations</b>	<b>15</b>
	Connect a computer	15
	Copy files	16
	Eject drive and disconnect computer	16
<b>5</b>	<b>Network Configuration</b>	<b>18</b>
	Choose a network service	18
	Configure sites	19

Set credentials (Volume password) .....	19
View network configuration .....	20
<b>6 Network Operations .....</b>	<b>21</b>
No sites configured .....	21
Sites configured .....	21
<b>7 Copy Storage Devices .....</b>	<b>22</b>
Copy naming conventions .....	22
• Folder naming conventions .....	23
Performing incremental copies .....	23
• Enabling incremental copies .....	24
Performing verifications .....	24
• Enabling copy verifications .....	24
<b>8 Crypto Erase .....</b>	<b>25</b>
<b>9 Recovery .....</b>	<b>26</b>
Manual recovery .....	27
<b>10 Settings .....</b>	<b>28</b>
Network .....	28
Copy storage device .....	28
Clock .....	28
Change password .....	29
<b>11 Support .....</b>	<b>30</b>
Update .....	30
• Manual .....	30
• Automatic .....	31
Generate diagnostic .....	31
Help .....	31
Recovery .....	31
Register .....	31
About .....	32
<b>12 Regulatory Compliance .....</b>	<b>33</b>
FCC DECLARATION OF CONFORMANCE .....	33
CLASS B .....	33
VCCI-B .....	33
China RoHS .....	33



# Introduction

Take control of your data transfer and transport costs when moving data around your enterprise. The Seagate® Lyve Drive™ Shuttle is available in storage options that are simple and affordable for emerging edge environments, regardless of cloud service provider. This shuttle supports most industry-standard file systems and network protocols for easy ingestion from direct-attached, network-attached, and other external storage devices.

For common questions and answers about your Seagate Lyve Drive Shuttle, visit [Seagate customer support](#).

## Box content

- Seagate® Lyve Drive™ Shuttle
- USB 3.1- USB C cable
- USB 3.1 - USB Type A cable
- Type C PD 3.0 power adapter
- Shipping case



**Important**—Save your packaging. If you experience problems with your device and want to exchange it, the device must be returned in its original packaging.

## Minimum system requirements

### Computer port

- USB Type A port (USB 3.0 or 2.0).
- USB Type C port (USB 3.1 or higher or Thunderbolt)

### Operating system

- Windows® 7 or higher
- macOS® 10.12 or higher

### Minimum free disk space

- 600MB recommended

# Specifications

## Dimensions

Side	Dimensions (in/mm)
Length	12.717 in/323 mm
Width	7.087 in/180 mm
Depth	3.543 in/90 mm

## Weight

Model	Weight (lb/kg)
2 x 4TB SATA SSD	8.774 lb/3.98 kg
16TB SATA HDD	9.921 lb/4.5 kg

## Electrical

Type C PD 3.0 power adapter (15V@3A)

**!** When charging the device using the power supply port, use only the power supply provided with your device. Power supplies from other Seagate and third-party devices can damage your Lyve Drive Shuttle.

## Temperature ranges

Ambient environment	Temperature range
Standard (operating)	0-35 °C

## Ports

Flip down the port door to reveal the input/output ports.

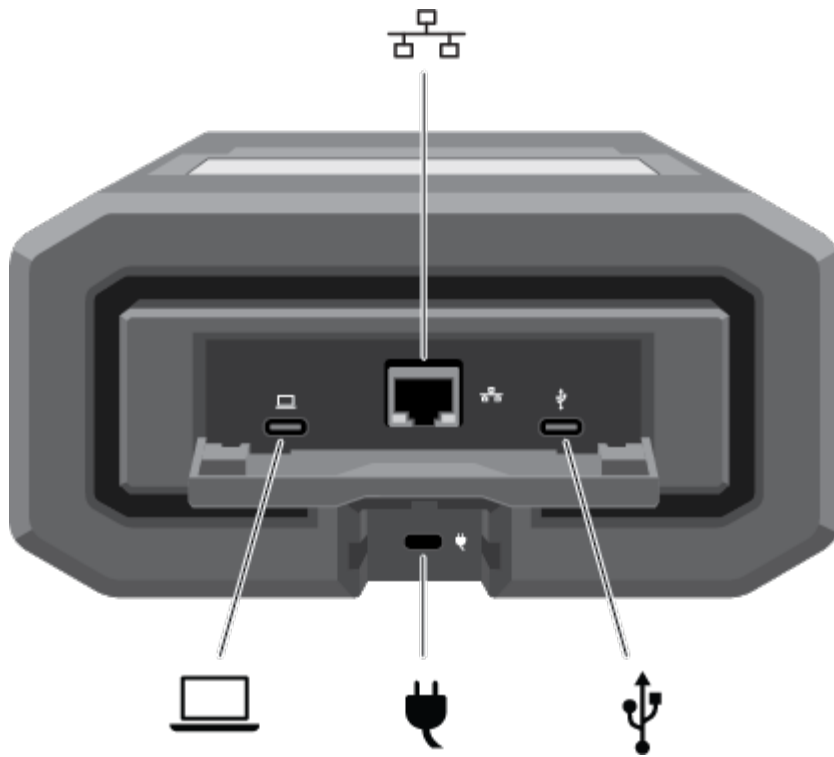

Host port (USB 3.1 Gen 2 Type C)—Connect to Windows and macOS computers.



Ethernet port (10 GbE)<sup>1</sup>—Connect to a network.



Power port (Type C PD 3.0)—Connect the power adapter (15V@3A).



Peripheral port (USB 3.1 Gen 2 Type C)—Connect to external USB storage.

## E-Ink screen

To open the cover on the E-Ink screen, push the button and slide the button away from the screen.

## Carrying handle

Press the two handle release buttons on each side of the handle. Once the handle is released, gently pull it open until it's fully extended.

To retract, push the handle back in until the latch catches.

## Status LED

The status LED is located above the handle. It is steady green when inactive and blinks during activity.

# Shipping case

A shipping case is included with Lyve Drive Shuttle. Always use the case when transporting and shipping the device. Lyve Drive Shuttle is well protected in its hard enclosure but is not manufactured to withstand the potentially damaging impacts that can occur with transport.

---

<sup>1</sup>Performance up to 5GbE.



# Getting Started

## 1 Connect the power cable

Connect the included power supply in the following order:

- A. Connect the power supply to Lyve Drive Shuttle's power input.
- B. Connect the power cord to the power supply.
- C. Connect the power cord to a live power outlet.

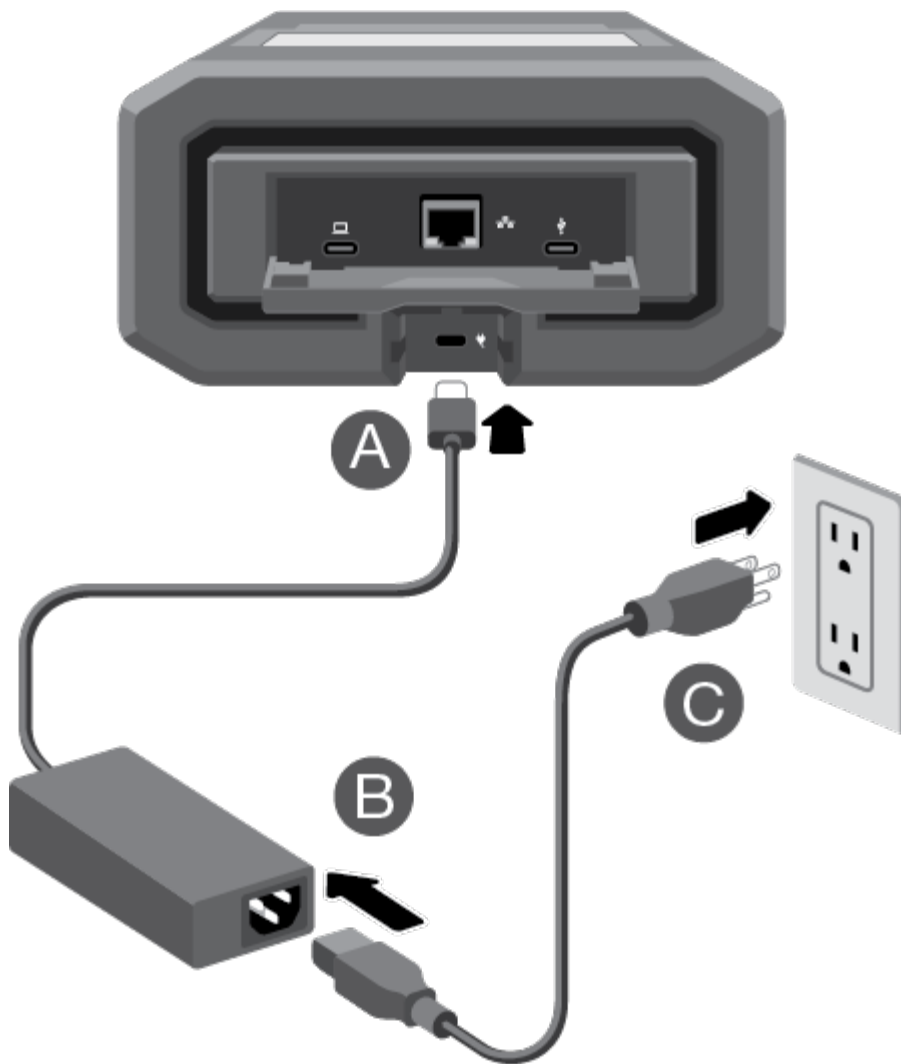

**!** Use only the power supply provided with your device. Power supplies from other Seagate and third-party devices can damage your Lyve Drive Shuttle.

## 2 View the E-Ink display

Follow the onscreen instructions to complete the setup.



When completing the setup, a popup prompts you to set the clock for Lyve Drive Shuttle. To make certain that your device has the correct date, time, and time zone, follow the prompt to the clock setting. You can also set the clock at any time by tapping on the Menu icon (☰) and selecting **Settings > Clock**.

## Lyve Drive Shuttle is ready

After setup is complete, tap an action to get started.

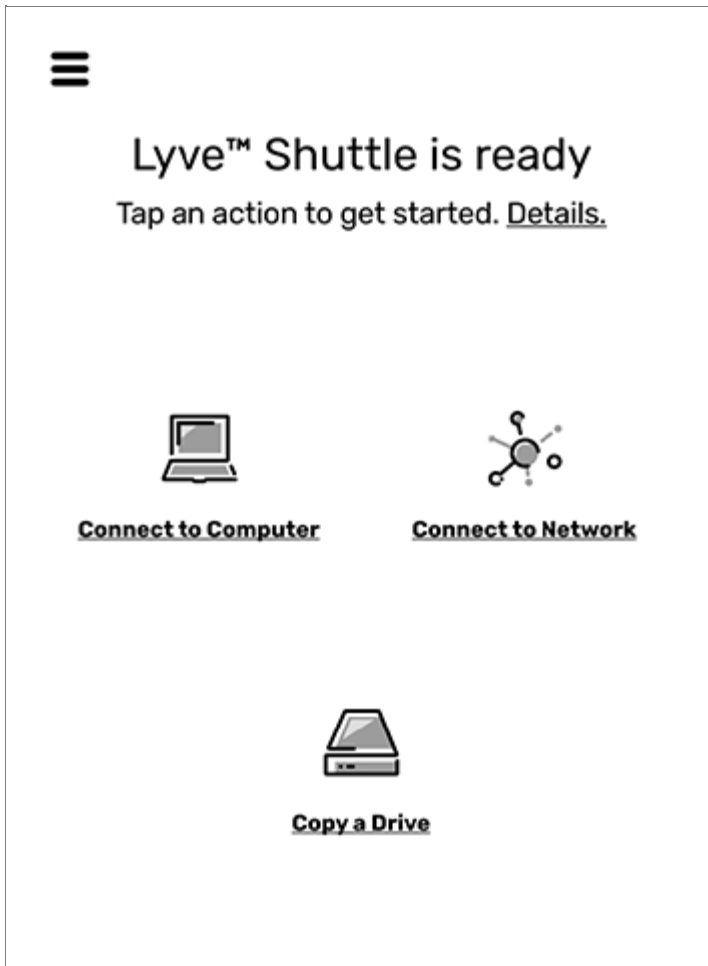

 For advanced network features such as NFS, site configurations, and volume password-protection, tap on the Menu icon (☰) and select **Settings > Network**.

## Initial configuration

Storage Format	exFAT for compatibility with Windows and macOS.
Internet Protocol	DHCP for easy network connectivity.
Network Protocol	SMB to share and password-protect the network volume.

## Site credentials

In addition to DHCP, you can set up unique network credentials for all your sites. Go to network settings to manage the device's credentials for quick connections when shuttling between sites. See [Network Configuration](#).

## Register Lyve Drive Shuttle

Get the most from Lyve Drive Shuttle with easy access to information and support.

To register your device:

1. On the Home screen, tap the Menu icon (☰).
2. Tap **Support**.
3. Tap **Register**.
4. Tap on the Name field and enter your name.
5. Tap on the Email field and enter your email address.
6. Tap **Register**.

## Power off/on Lyve Drive Shuttle

To power off Lyve Drive Shuttle:

1. On the Home screen, tap the Menu icon (☰).
2. Tap **Shut Down**.

Lyve Drive Shuttle does not have a power button. To power on the device, disconnect and reconnect the power cable.



In the event Lyve Drive Shuttle is abruptly disconnected from power, it will restart automatically when the power cable is reconnected. The E-ink screen may display random pixels during the reboot sequence. This behavior is normal.

# Security

Securely encrypt stored data on Lyve Drive Shuttle with Seagate Secure™, which protects data via industry standard AES-based hardware encryption. Lyve Drive Shuttle's enhanced encryption keeps your data safe should someone attempt to remove the storage device. The storage device can only be unlocked when it is safely housed within Lyve Drive Shuttle and will not work if it is removed.

## Create a password

Lyve Drive Shuttle can only be unlocked by the device password. During the initial setup, you are prompted to create a password. A minimum of 6 characters are required.

Some tips for creating a strong password:

- Combine numbers, special characters, and upper and lower case letters.
- Use more than the minimum 6 characters.
- Avoid predictable number sequences such as 123456.
- Avoid predictable keyboard sequences such as QWERTY.
- Avoid repeated characters such as 111111 or AAAAAA.



Create a password that is easy to remember, and store it in a safe place. Similar to mobile phones, your password cannot be recovered, not even by Seagate.

## Change a password

To change your current password:

1. On the Home screen, tap the Menu icon (☰).
2. Tap **Settings**.
3. Tap **Change Password**.
4. Enter your current password and tap **Next**.
5. Enter your new password and tap **Next**.
6. Re-enter your new password and tap **Change**.

## Unlock device

Lyve Drive Shuttle can only be accessed with your password.

To unlock the device:

1. Connect the power cable to power on the device.
2. Enter your password.
3. Tap **Unlock**.

## Lock device

To lock the device:

1. On the Home screen, tap the Menu icon (☰).
2. Tap **Lock**.

# Desktop Operations

You can connect a computer to Lyve Drive Shuttle's USB host port. Once connected, you can copy files to Lyve Drive Shuttle.

## Connect a computer

To connect a computer:

1. On the Home screen, tap **Connect to Computer**.
2. Connect a computer to Lyve Drive Shuttle's USB host port.

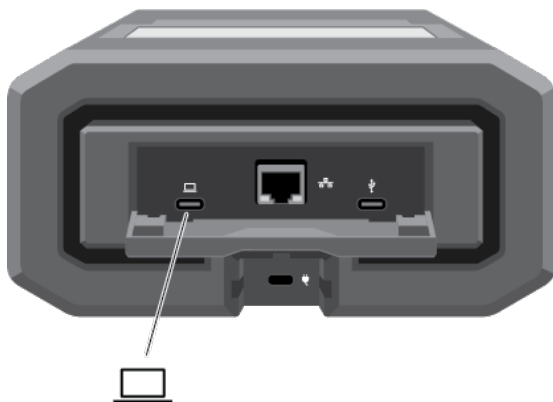

3. Wait for Lyve Drive Shuttle to detect and connect to your computer.

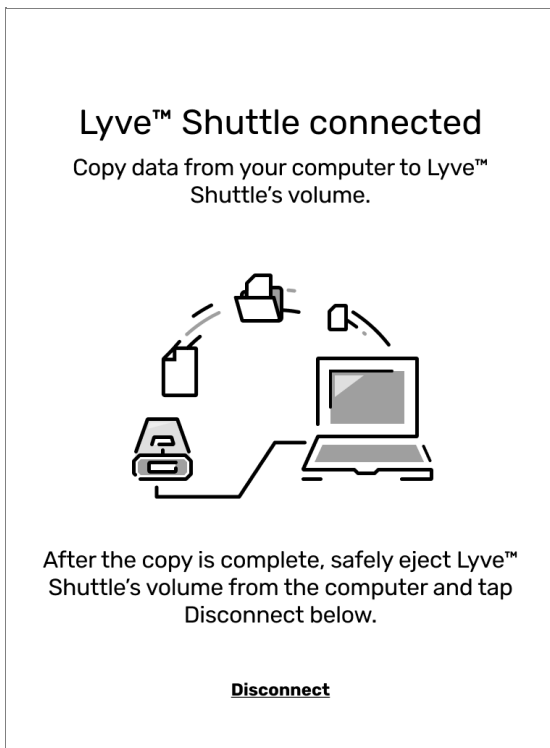

## Copy files

To copy files to Lyve Drive Shuttle:

1. With your computer connected to Lyve Drive Shuttle, open a computer file browser window and navigate to the location on Lyve Drive Shuttle where you want to locate your copied files.
2. Open a second file browser window and select files to copy.
3. Drag the files to the target location on Lyve Drive Shuttle.
4. Wait for the copy operation to complete.

## Eject drive and disconnect computer

To eject and disconnect Lyve Drive Shuttle:

1. Confirm that all copy operations are complete, and then use your computer's operating system to safely eject Lyve Drive Shuttle.



Always safely eject Lyve Drive Shuttle from your computer before physically disconnecting it. Your computer must perform filing and housekeeping operations on the drive before it is removed. If you unplug the drive without using the operating system's software, your files can become corrupt or damaged.

2. Using the E-ink screen, tap **Disconnect**.



## Lyve™ Shuttle connected

Copy data from your computer to Lyve™ Shuttle's volume.

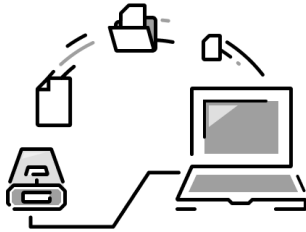

After the copy is complete, safely eject Lyve™ Shuttle's volume from the computer and tap Disconnect below.

**Disconnect**

3. At the prompt, confirm by tapping **Disconnect**.

## Lyve™ Shuttle connected

Copy data from your computer to the Lyve™ Shuttle's volume

### Disconnect

Disconnecting Lyve™ Shuttle cancels any activity in progress. Confirm that all copies from your computer are complete.

Cancel

Disconnect

After the copy is complete, safely eject Lyve™ Shuttle's volume from the computer and tap Disconnect below.

**Disconnect**

# Network Configuration

Use the Network Settings screen to select a network service, configure sites, and create user credentials for accessing Lyve Drive Shuttle's volume.

To navigate to the Network Settings screen:

1. On the Home screen, tap the Menu icon (☰).
2. Tap **Settings**.
3. Tap **Network**.

## Choose a network service

Lyve Drive Shuttle supports two communication protocols used for sharing access to network resources:

---

<b>SMB (Default)</b>	<ul style="list-style-type: none"><li>• SMB supports any storage format.</li><li>• SMB supports network volume credentials.</li></ul>
<b>NFS</b>	<ul style="list-style-type: none"><li>• Only works with Lyve Drive Shuttle formatted as EXT4.</li><li>• EXT4 is not native to macOS and Windows, which can conflict with USB connectivity.</li><li>• Does not support network volume credentials.</li><li>• After applying NFS, the device is crypto-erased and the storage formatted as EXT4. All items stored on the device will be deleted.</li></ul>

---

To choose a service:

1. On the Network screen, tap **Choose Service**.
2. Tap **SMB** or **NFS**.

! If you choose NFS, Lyve Drive Shuttle will be crypto erased and the storage formatted as EXT4. All items stored on the device will be deleted.

3. Tap **Apply**.

# Configure sites

Some of the sites you connect to may require static IP addresses rather than Dynamic Host Configuration Protocol (DHCP). Lyve Drive Shuttle walks you through adding network information for sites using static IP addresses. Once a site is configured, you can [choose it](#) when selecting a network connection from the Home screen.

To add a site:

1. On the Network screen, tap **Configure Sites**.
2. Tap **Add site**.
3. Follow the onscreen prompts to create the following:
  - Site name
  - Fixed IP address
  - Subnet mask
  - Router address
  - Hostname
4. Tap **Create** to complete the site configuration.

To edit an existing site:

1. On the Network screen, tap **Configure Sites**.
2. Tap on the name of an existing site.
3. Follow the onscreen prompts to revise data.
4. Tap **Create** to complete the site configuration.

## Set credentials (Volume password)

Add an extra layer of security by creating a username and password to access the Lyve Drive Shuttle volume on the network. This is only available with SMB as the service and cannot be used with NFS. The default name of the volume is Lyve Drive Shuttle.

To add or edit credentials:

1. On the Network screen, tap **Set Credentials**.
2. The device password is required to edit network credentials for Lyve Drive Shuttle's volume. Enter the device password and tap **Next**.
3. Tap on the Username field and then use the keyboard to enter a username.
4. Tap on the Password field and use the keyboard to enter a password.
5. Tap **Create**.
6. Review the newly created credentials on the Network Credentials screen. You can also edit or delete users on this screen.

## ! Accessing Lyve Drive Shuttle on a Windows computer connected to a domain

If you're using a Windows machine connected to a domain, your Lyve Drive Shuttle username/password credentials must match your domain credentials in order to access the Lyve Drive Shuttle's volume over the network. See this [knowledge base article](#) for more details.

## View network configuration

You can view and edit configuration details of Lyve Drive Shuttle's current network.

To view configuration details of the current network:

1. On the Network screen, tap **View Configuration**.
2. Tap on a detail to edit as needed.
3. Tap **Back** to exit.

# Network Operations

## No sites configured

To connect to a network:

1. On the Home screen, tap **Connect to Network**.
2. Connect Lyve Drive Shuttle's Ethernet port to a network.
3. Once Lyve Drive Shuttle is connected, you can copy data from computers on the network to Lyve Drive Shuttle's volume.
4. If you need details on the configuration of the connected network, tap **Info**.
5. When you're finished, tap **Disconnect**.

## Sites configured

To connect to a network:

1. On the Home screen, tap **Connect to Network**.
2. Connect Lyve Drive Shuttle's Ethernet port to a network.
3. On the Connect to Network screen, do one of the following:
  - If you're connecting to a dynamic host site, tap **DHCP**.
  - If you're connecting to a static site you added previously, tap the name of the site. If you need to [configure a new site](#), tap **Add site** and follow the onscreen prompts. Up to five sites can be configured.
4. Once Lyve Drive Shuttle is connected, you can copy data from computers on the network to Lyve Drive Shuttle's volume.
5. If you need details on the configuration of the connected network, tap **Info**.
6. When you're finished, tap **Disconnect**.

# Copy Storage Devices

You can initiate an automated copy of data from a USB-connected device.

To begin the copy:

1. On the Home screen, tap **Copy a Drive**.
2. Connect a device to Lyve Drive Shuttle's USB port.

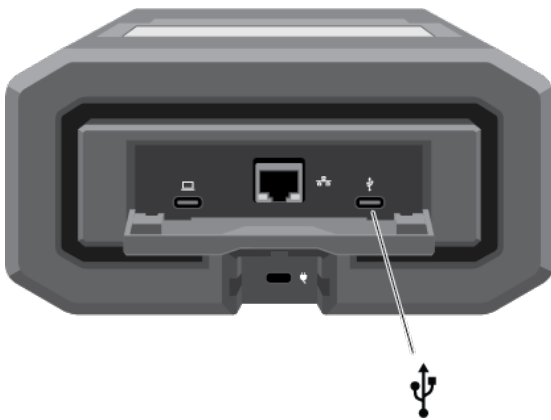

3. Lyve Drive Shuttle searches for connected devices. At the prompt, select the source to copy to Lyve Drive Shuttle and tap **Copy**.
4. When copying is complete, view the results and tap **OK**.

## Copy naming conventions

During a copy, Lyve Drive Shuttle creates folders using the following naming convention:

YYYYMMDD.HHMM.UUID.N

These folders are stored in the Backups folder on the root of the Lyve Drive Shuttle.

---

**YYYY** Year

---

**MM** Month

---

**DD** Day

---

**HH** Hour (24-hour clock)

---

<b>MM</b>	Minutes
<b>UUID</b>	Universally unique identifier designating the device from which the files were copied
<b>N</b>	Session number

Take for example the following directory:

20201001.1306.XFGT6G.1

Lyve Drive Shuttle would have created this directory on October 1, 2020, at 1:06pm. The source of the content was a device with a UUID of XFGT6G. This was the first upload of content from this device on this day.

## Folder naming conventions

When viewing your copied files in **Lyve Drive Shuttle > Backups**, folder names created during incremental copies are appended with `_update`. Folder names from copies that were interrupted are appended with `_incomplete`.

Backup type	Sample folder name
<b>Full</b>	20200401_1120_Garmin_VirbUltra30_878555
<b>Incremental</b>	20200401_1120_Garmin_VirbUltra30_878555_update
<b>Incomplete</b>	20200401_1120_Garmin_VirbUltra30_878555_incomplete

## Performing incremental copies

When a new storage device is detected, Lyve Drive Shuttle will copy all files from the source. If the same drive is connected again at a later date, Lyve Drive Shuttle will perform either a full or incremental copy, depending on your copy settings.

<b>Full</b>	All files on the storage device are copied, regardless of whether some or even all files on the device were copied previously.
<b>Incremental</b>	Only new files on a previously ingested storage devices are copied to Lyve Drive Shuttle. Incremental copies can save storage space and copying time.

## Enabling incremental copies

To enable incremental copies:

1. On the Home screen, tap the Menu icon (☰).
2. Tap **Settings**.
3. Tap **Copy Storage Device**.
4. Make sure the **Incremental** checkbox is selected.
5. Tap **Back**.

## Performing verifications

Verification checks the integrity of files for all copies. Enabling this option doubles the time to copy.

## Enabling copy verifications

To enable copy verifications:

1. On the Home screen, tap the Menu icon (☰).
2. Tap **Settings**.
3. Tap **Copy Storage Device**.
4. Make sure the **Verify** checkbox is selected.
5. Tap **Back**.



# Crypto Erase

A crypto erase securely deletes all data on Lyve Drive Shuttle. **Data cannot be recovered after a crypto erase.** Your security settings and password remain unchanged.

To crypto erase the device:

1. On the Home screen, tap the Menu icon (☰).
2. Tap **Crypto Erase**.
3. At the prompt, tap **Next**.
4. Enter your password and tap **Next**.
5. The drive will be reformatted after erasing data. Select a storage format and tap **Erase**.
6. At the prompt, tap **Erase** to confirm the crypto erase.
7. When the crypto erase is complete, tap **OK**.

# Recovery

If an internal issue is detected when starting, Lyve Drive Shuttle may automatically initiate a recovery.

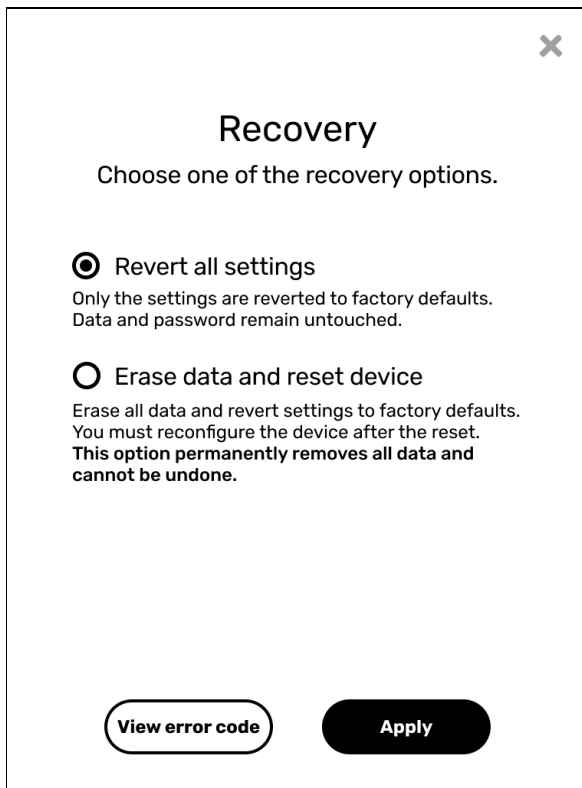

To complete the recovery:

1. Tap to choose one of the recovery options:

<b>Revert all settings</b>	Revert only settings to factory defaults. Data and password remain untouched.
<b>Erase data and reset device</b>	Erase all data and revert settings to factory defaults. You must reconfigure the device after the reset. <b>This option permanently removes all data and cannot be undone.</b>

2. Tap **Apply**.
3. At the prompt, confirm your choice by tapping **Revert**.
4. When the recovery is complete, tap **Power off**.
5. To power on Lyve Drive Shuttle, disconnect and reconnect the power cable.

# Manual recovery

To initiate a manual recovery:

1. On the Home screen, tap the Menu icon (☰) and select **Support > Recovery**.
2. Follow the instructions above.

# Settings

To view and change Lyve Drive Shuttle settings:

1. On the Home screen, tap the Menu icon (☰).
2. Tap **Settings**.
3. Select an option from the Settings menu.

## Network

Network settings let you configure network sites, services, and credentials. See [Network Configuration](#) for details.

## Copy storage device

You can initiate an automated copy of data from a USB-connected storage device. See [Copy Storage Devices](#) for details.

To view and change copy settings:

1. In the Settings menu, tap **Copy Storage Device**.
2. Tap checkboxes to enable/disable copy options:

---

<b>Incremental</b>	Only copy new content added to previously copied storage devices.
<b>Verify</b>	Verification checks the integrity of files for all copies. Enabling this option doubles the time to copy.

---

3. Tap **Back**.

## Clock

You can set the date, time, time zone, and clock (12-hour/24-hour) for Lyve Drive Shuttle.

To edit clock settings:

1. In the Settings menu, tap **Clock**.

2. Tap **12H** or **24h** to set the clock (12-hour/24-hour).
3. Tap **Edit**.
4. On the Choose time zone screen, tap on the Search icon.
5. Enter a time zone, city, or country and tap **Search**.
6. Select a time zone from the search results and tap **Next**.
7. On the Set clock screen, tap the Up/Down arrows to change the Month/Day/Year and Hour/Minutes settings. If the device is using a 12-hour clock, you can also set AM/PM.
8. Tap **Apply**.

## Change password

A device password is created during the initial setup (see [Security](#)).

To change your current password:

1. In the Settings menu, tap **Change Password**.
2. Enter your current password and tap **Next**.
3. Enter your new password and tap **Next**.
4. Re-enter your new password and tap **Change**.

# Support

Get the most from Lyve Drive Shuttle with easy access to information and support.

To select support activities:

1. On the Home screen, tap the Menu icon (☰).
2. Tap **Support**.
3. Select an activity from the menu.

## Update

Lyve Drive Shuttle's firmware may need to be updated as part of routine maintenance or in order to resolve a specific issue.

To initiate a firmware update:

1. In the Support menu, tap **Update**.
2. At the prompt, select from the following options:

---

<b>Manual</b>	Download the firmware from a Seagate website to an external storage device, and then have Lyve Drive Shuttle access the file.
<b>Automatic</b>	Allow Lyve Drive Shuttle to check for updates when connected to the internet via a network connection. <b>Internet connection required.</b>

---

## Manual

To complete a manual firmware update:

1. From a computer, download the firmware at [www.seagate.com/support/lyve-drive-shuttle](http://www.seagate.com/support/lyve-drive-shuttle).
2. Copy the firmware to an external storage device. It must be copied to the root level of the hard drive.
3. Connect the drive to Lyve Drive Shuttle's peripheral port and tap **Next**.
4. At the prompt, tap **Power off** to begin the update.
5. At the prompt, disconnect and reconnect the power cable.
6. When the update is complete, tap **Power off** to complete the update.
7. To power on Lyve Drive Shuttle, disconnect and reconnect the power cable.

## Automatic

To complete an automatic firmware update:

1. After the update is downloaded, Lyve Drive Shuttle will power off.
2. You're prompted to power on the device to run the update. Disconnect and reconnect the power cable. Lyve Drive Shuttle will automatically update when powering on.

## Generate diagnostic

If you've contacted Seagate support about a technical problem with Lyve Drive Shuttle, a representative may ask you to download a diagnostic report to aid in troubleshooting the issue.

To generate a diagnostic report:

1. In the Support menu, tap **Generate Diagnostic**.
2. Connect an external storage device to the USB peripheral port and tap **Create log**.
3. At the prompt, tap **OK**.

Once the log has been downloaded, disconnect the external storage device and connect it to computer. Follow the instructions from your Seagate representative on sending the log to Seagate support.

## Help

Lyve Drive Shuttle provides the URL for the support page for Live Drive Shuttle.

To view the URL:

1. In the Support menu, tap **Help**.
2. Note the support URL: [www.seagate.com/support/lyve-drive-shuttle](http://www.seagate.com/support/lyve-drive-shuttle).

## Recovery

A recovery is used to revert Lyve Drive Shuttle to its factory default settings. See [Recovery](#) for details.

## Register

Get the most from Lyve Drive Shuttle with easy access to information and support.

To register your device:

1. In the Support menu, tap **Register**.

2. Tap on the Name field and enter your name.
3. Tap on the Email field and enter your email address.
4. Tap **Register**.

## About

The About screen displays details about Lyve Drive Shuttle.

To view the About screen:

1. In the Support menu, tap **About**.
2. Review the following device details:
  - Product name
  - Device name
  - Model name
  - Firmware version
  - Serial number
3. Tap **Back**.

Lyve Drive Shuttle uses open source libraries. You can download acknowledgements and licenses:

1. On the About screen, tap **Acknowledgements & Licenses**.
2. Connect a storage device and tap **Download**.
3. Review the download results and tap **OK**.



# Regulatory Compliance

Product Name	Regulatory Model Number
Seagate Lyve Drive Shuttle	SUP001S

## FCC DECLARATION OF CONFORMANCE

This device complies with Part 15 of the FCC Rules. Operation is subject to the following two conditions: (1) this device may not cause harmful interference, and (2) this device must accept any interference received, including interference that may cause undesired operation.

## CLASS B

This equipment has been tested and found to comply with the limits for a Class B digital device, pursuant to Part 15 of the FCC Rules. These limits are designed to provide reasonable protection against harmful interference in residential installation. This equipment generates, uses, and can radiate radio frequency energy and, if not installed and used in accordance with the instructions, may cause harmful interference to radio communications. However, there is no guarantee that interference will not occur in a particular installation. If this equipment does cause harmful interference to radio or television reception, which can be determined by turning the equipment off and on, the user is encouraged to try to correct the interference by one or more of the following measures:

1. Reorient or relocate the receiving antenna.
2. Increase the separation between the equipment and receiver.
3. Connect the equipment into an outlet on a circuit different from that to which the receiver is connected.
4. Consult the dealer or an experienced radio/TV technician for help.

**CAUTION:** Any changes or modifications made to this equipment may void the user's authority to operate this equipment.

## VCCI-B

この装置は、クラスB機器です。この装置は、住宅環境で使用することを目的としていますが、この装置がラジオやテレビジョン受信機に近接して使用されると、受信障害を引き起こすことがあります。取扱説明書に従って正しい取り扱いをして下さい。VCCI-B

## China RoHS



China RoHS 2 refers to the Ministry of Industry and Information Technology Order No. 32, effective July 1, 2016, titled Management Methods for the Restriction of the Use of Hazardous Substances in Electrical and Electronic Products. To comply with China RoHS 2, we determined this product's Environmental Protection Use Period (EPUP) to be 20 years in accordance with the Marking for the Restricted Use of Hazardous Substances in Electronic and Electrical Products, SJ/T 11364-2014.

中国 RoHS 2 是指 2016 年 7 月 1 日起施行的工业和信息化部令第 32 号“电力电子产品限制使用有害物质管理办法”。为了符合中国 RoHS 2 的要求，我们根据“电子电气产品有害物质限制使用标识”(SJ/T 11364-2014) 确定本产品的环保使用期 (EPUP) 为 20 年。

部件名称 Part Name	有害物质 Hazardous Substances					
	铅 (Pb)	汞 (Hg)	镉 (Cd)	六价铬 (Cr <sup>6+</sup> )	多溴联苯 (PBB)	多溴二苯醚 (PBDE)
硬盘驱动器 / 固态硬盘 HDD / SSD	X	O	O	O	O	O
外接硬盘印刷电路板 Bridge PCBA	X	O	O	O	O	O
电源 (如果提供) Power Supply (if provided)	X	O	O	O	O	O
接口电缆 (如果提供) Interface cable (if provided)	X	O	O	O	O	O
其他外壳组件 Other enclosure components	O	O	O	O	O	O

本表格依据 SJ/T 11364 的规定编制。  
This table is prepared in accordance with the provisions of SJ/T 11364-2014

O: 表示该有害物质在该部件所有均质材料中的含量均在 GB/T 26572 规定的限量要求以下。  
O: Indicates that the hazardous substance contained in all of the homogeneous materials for this part is below the limit requirement of GB/T 26572.

X: 表示该有害物质至少在该部件的某一均质材料中的含量超出 GB/T 26572 规定的限量要求。  
X: Indicates that the hazardous substance contained in at least one of the homogeneous materials used for this part is above the limit requirement of GB/T 26572.

## Taiwan RoHS

Taiwan RoHS refers to the Taiwan Bureau of Standards, Metrology and Inspection's (BSMI's) requirements in standard CNS 15663, Guidance to reduction of the restricted chemical substances in electrical and electronic equipment. Beginning on January 1, 2018, Seagate products must comply with the "Marking of presence" requirements in Section 5 of CNS 15663. This product is Taiwan RoHS compliant. The following table meets the Section 5 "Marking of presence" requirements.

台灣RoHS是指台灣標準局計量檢驗局(BSMI)對標準CNS15663要求的減排電子電氣設備限用化學物質指引。從2018年1月1日起，Seagate產品必須符合CNS15663第5節「含有標示」要求。本產品符合台灣RoHS。下表符合第5節「含有標示」要求。

產品名稱：外接式硬碟，型號：SUP001S		Product Name: Lyve Drive Shuttle, Model: SUP001S				
產品名稱：外接式固態硬碟，型號：SUP001S		Product Name: Lyve Drive Shuttle, Model: SUP001S				
單元 Unit	限用物質及其化學符號 Restricted Substance and its chemical symbol					
	鉛 (Pb)	汞 (Hg)	鎘 (Cd)	六價鉻 (Cr <sup>6+</sup> )	多溴聯苯 (PBB)	多溴二苯醚 (PBDE)
硬盤驅動器 / 固態驅動器 HDD / SSD	—	○	○	○	○	○
外接硬盤印刷電路板 Bridge PCBA	—	○	○	○	○	○
電源 (如果提供) Power Supply (if provided)	—	○	○	○	○	○
傳輸線材 (如果提供) Interface cable (if provided)	—	○	○	○	○	○
其他外觀組件 Other enclosure components	○	○	○	○	○	○
備考 1. "○" 係指該項限用物質之百分比含量未超出百分比含量基準值。 Note 1. "○" indicates that the percentage content of the restricted substance does not exceed the percentage of reference value of presence.						
備考 2. "—" 係指該項限用物質為排除項目。 Note 2. "—" indicates that the restricted substance corresponds to the exemption.						