



Seagate M.2 NVMe SSD Installation Guide



Click here to access an up-to-date online version
of this document. You will also find the most recent content as well as expandable illustrations, easier navigation, and search capability.

Contents

1	Introduction	3
	Recommendations	3
	• Before installation	3
	Precautions	3
	Parts	3
	System Requirements	3
	Required tools	4
2	Installation	5
	Install Seagate M.2 NVMe SSD	5
3	Support & Services	7
	SeaTools	7
	DiscWizard	7
	Firmware download and tools download for secure erase	7
	Internal SSD support	7
	Online support and services	7
	Warranty support	7
	Data recovery services	7
	Seagate Partner Program	7

Introduction

Recommendations

- Intended for desktop PCs.
- Seagate® M.2 NVMe® SSDs come in the single-sided or double-sided M.2 2280 form factor with the following maximum dimensions: 80.85mm (L) x 24.15mm (W) x 3.58mm (H). Verify that your system provides enough space for installation.
- For optimal performance, provide sufficient airflow and cooling. Use a motherboard-integrated heatsink and cooling system.

Before installation

! **IMPORTANT** Make certain your computer's BIOS is up to date before installing M.2 SSD. See your computer or motherboard documentation for information on how to access the BIOS.

- Most motherboards have more than one M.2 slot available for SSD drives. Before installing M.2 NVMe SSD:
 - Determine the appropriate M.2 slot on your motherboard. If another SSD drive is already installed in the slot, you'll need to remove it during the installation.
 - Decide whether you want to install your computer operating system on M.2 SSD and use it as your primary drive. See your computer or motherboard documentation for details on how to boot from M.2 SSD.
 - If you need to transfer files from another drive to M.2 SSD, consider how you will move your data or clone your drive before starting the installation.

Precautions

- Unpack the SSD.
- Inspect the SSD for any damages.
- For the safety of your SSD, take precautions to avoid electrostatic discharge. Power down and power drain your computer according to the instructions provided in the computer product documentation.
- Back up the data from the existing storage device.

Parts

Seagate M.2 NVMe SSD

System Requirements

- M.2 (M-key) slot with compatible PCIe® interface. To ensure your system can utilize the full potential

- M.2 (M key) slot with compatible PCIe® interface. To ensure your system can utilize the full potential of your SSD, verify that both your motherboard and CPU support the same PCIe generation as your SSD.
- Windows® 10 or higher

Required tools

Appropriate screwdriver and screw to fasten M.2 SSD to your motherboard.

Installation

Install Seagate M.2 NVMe SSD

1. Before installing M.2 SSD, power down your computer and unplug any cables attached to it.
2. Open the case or cabinet.
3. If an existing SSD drive is installed in the M.2 PCIe slot you intend to use for M.2 SSD, you'll need to remove it.
4. Power on your computer.
5. Access the BIOS setup while the computer is booting. Ensure that a PCIe device is set in the BIOS boot sequence or boot priority list.
6. Power down the computer and locate the M.2 PCIe slot on your motherboard.



Note—Some motherboards have a pad installed in the **M.2_PAD** space by default. This pad can be removed to ensure a better fit for M.2 SSD.

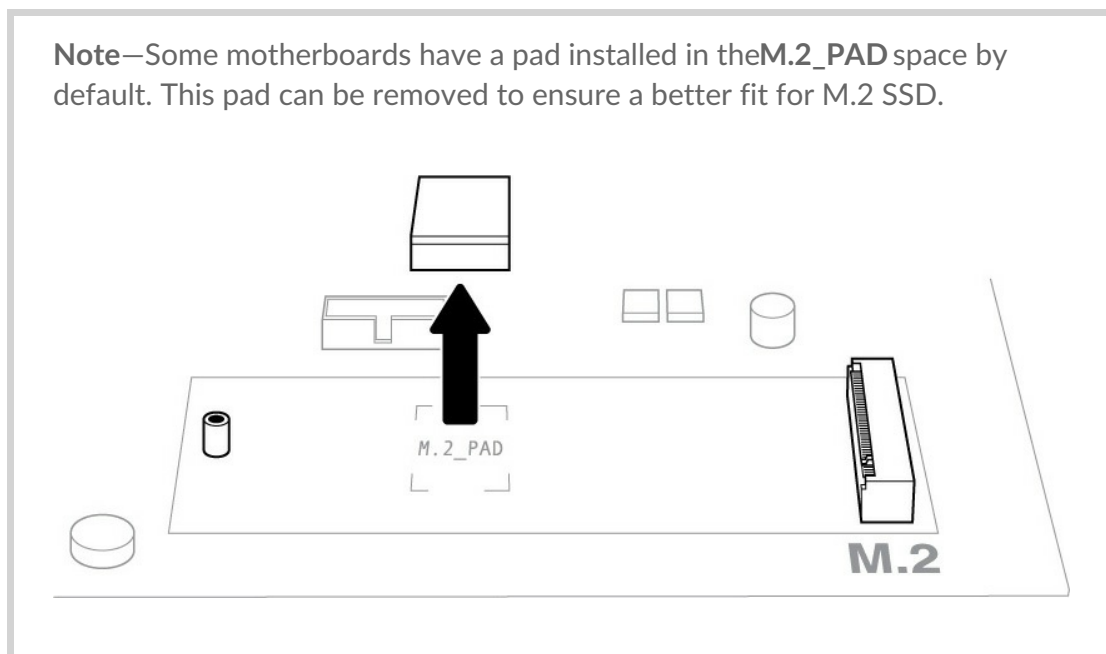

7. Check to make sure that the notch on M.2 SSD is correctly aligned with the divider in the slot. Gently push M.2 SSD into the slot until it's firmly seated.

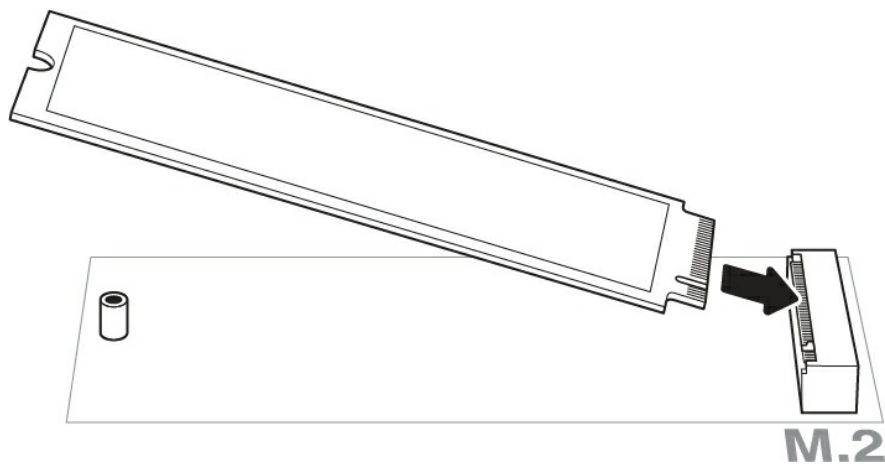

8. Hold down M.2 SSD while you fasten the mounting screw. Make sure the SSD is secured in place.

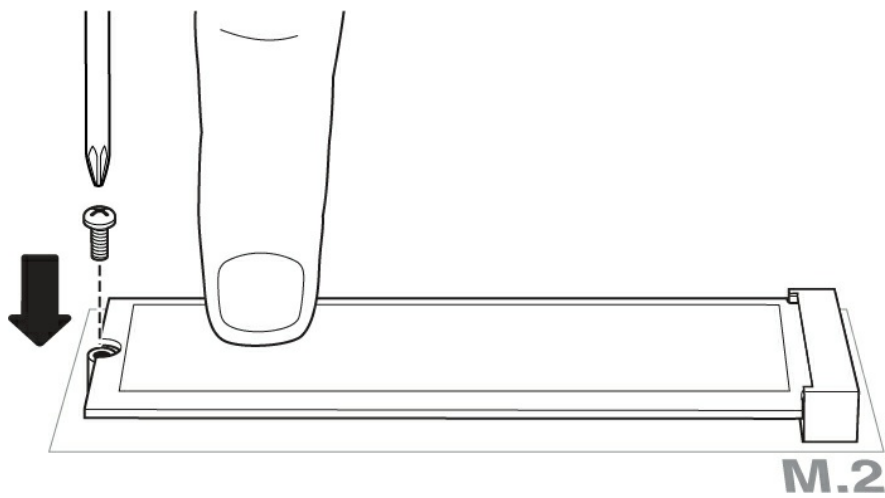

9. Close the case or cabinet and reassemble your computer.
10. Power on your computer.
11. Install the computer operating system on M.2 SSD if you want to use it as the primary drive.

Support & Services

SeaTools

SeaTools™ SSD GUI is a free utility that lets you monitor and maintain your drive's health, status, and tests. Go to www.seagate.com/support/downloads/seatools

DiscWizard

Seagate DiscWizard is an integrated software suite that lets you back up your operating system, applications, settings, and files, while also securely destroying confidential data you no longer need. Go to www.seagate.com/support/downloads/discwizard

Firmware download and tools download for secure erase

Go to www.seagate.com/support/downloads

Internal SSD support

Go to www.seagate.com/support/products

Online support and services

Go to www.seagate.com/contacts

Warranty support

Go to www.seagate.com/warranty.

Data recovery services

Go to www.seagate.com/rescue

Seagate Partner Program

Go to www.seagate.com/partners.