

Quick Start Guide

Handling Precautions

Handle your drive with care! The following precautions can help prevent loss of data or damage to your drive:

- Do not drop, jar or bump the QuickView Expander drive.
- Do not stack your QuickView Expander drive on top of other component cooling vent holes or block airflow to other components.
- Do not set the drive on its side without using the vertical stand.
- Do not remove any cables or power cords without properly powering down the set top box, as instructed in your set top box manual.
- Do not set any liquids or drinks on the drive. Liquids will damage the internal electronics.
- Do not open the drive's case.
- Do not place equipment in front of or behind your drive. Doing this will restrict airflow that helps keep the drive cool.

Included in this Kit



Maxtor QuickView Expander Drive

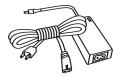

Power Adapter



ESATA Cable

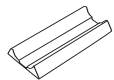

Vertical Stand



Rubber Feet

Product Features

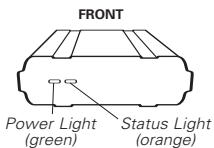

Power Light (green) Status Light (orange)

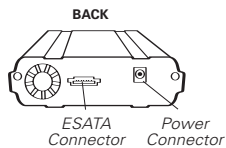

ESATA Connector Power Connector

Setup

- 1 Verify the recording space available on your Digital Video Recorder (DVR).

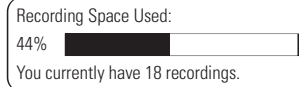

Write down the percentage of available space then power down and disconnect the power cable from your DVR.

- 2 Connect power to a suitable wall outlet or power strip. Do not use the auxiliary power connector on the back of the DVR.



See reverse side for important information about attaching the QuickView Expander drive to an electrical outlet.

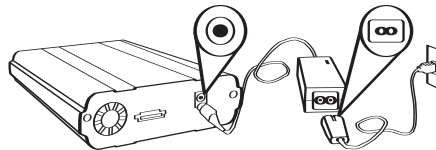

The Green power light should display solid and the orange status light should start flashing after powering up the Quickview Expander drive.

- 3 Connect the ESATA cable to the back of the Quickview Expander drive and the DVR.

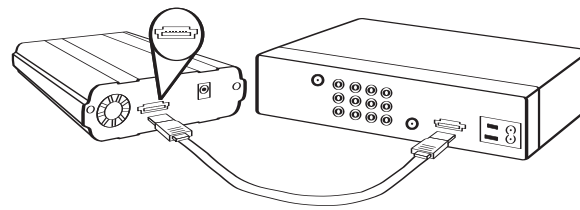

After power is reconnected and the DVR is powered up, the orange status light should stop flashing.

- 4 Check available recording space. If the Quickview Expander was detected properly by the DVR, your available recording space should have increased.



Display Lights

Your QuickView Expander drive is equipped with two display lights. Each light communicates the health and operation of the drive.

Status light only valid when the power light is on.

POWER	MESSAGE
ON	The drive is on and running.
OFF	The drive is off.

STATUS	MESSAGE
1 blink	Light will blink once after product is plugged in.
2 blinks	The SATA cable is not connected to the set top box.
8 blinks or continuous	There is an internal error. Contact your service provider or www.maxtor.com .

Adding rubber feet to your QuickView Expander Drive

If you plan to use your drive on a flat surface, your kit includes four rubber feet to protect your drive and the surface it is on.

To apply the feet:

1. Make sure your QuickView Expander drive is disconnected properly from your DVR, and the drive is turned off.
2. The feet go on the bottom of your drive. Apply feet as illustrated on bottom of your drive.
3. Return the drive to its upright position, so it rests on the rubber feet.



POWER CONNECTION CAUTION

Important Notice

Some Digital Video Recorders (DVR) will have auxiliary power outlets on the back of them.

Power outlets on the back of DVR's should not be used to power the QuickView Expander drive. Doing so may be detrimental to the drive and the content you are recording.

When installing your QuickView Expander drive, make sure you plug the power cord for the drive into a wall outlet or power strip.

Do not remove any cables or power cords from the QuickView Expander without first disconnecting the external ESATA cable from the DVR. Failure to disconnect the external ESATA cable first could damage the drive or the content you are recording.

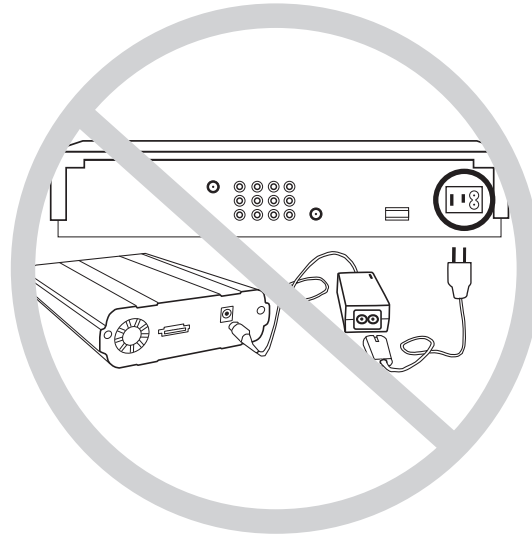

Incorrect way to connect power to QuickView Expander drive

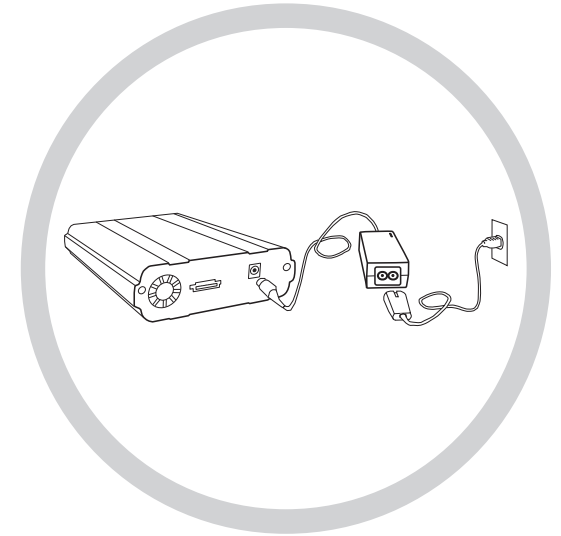

Correct way to connect power to QuickView Expander drive

ADDITIONAL CAUTIONS AND INFORMATION

Your cable service provider must enable and continue the connection to your Digital Video Recorder (DVR) for the QuickView Expander Drive to record.

Your service provider is responsible for all warranty and support services regarding your Cable and DVR. For additional information regarding the operation of your DVR, please contact your cable service provider.

The QuickView Expander drive cannot be used with more than one DVR.

Content will only be recognized by the DVR originally connected to the QuickView Expander.

The QuickView Expander is not designed to operate with a personal computer.

For additional information or troubleshooting help with your QuickView Expander drive, please visit www.maxtor.com

© 2005 Maxtor Corporation. For purposes of measuring drive capacity, one gigabyte (GB) refers to one billion bytes. Maxtor and the Maxtor stylized logo are registered trademarks, and QuickView Expander is a trademark, of Maxtor Corporation.

www.maxtor.com

Maxtor P/N: 20260803